

BILL OF MATERIALS		
PART NO	LUMBER AND SIZE OF MATERIAL	STANDARD STOCK TO CUT MATERIAL FROM
1	6 PC. 2" x 4" x 2'-6"	2 PC. 2" x 4" x 8'-0"
2	2 PC 2" x 4" x 5'-8"	3 PC 2" x 4" x 12'-0"
3	4 PC 2" x 4" x 5'-8"	7 PC 1" x 6" x 8'-0"
4	26 PC 1" x 6" x 2'-0"	6 PC 1" x 6" x 12'-0"
5	4 PC 1" x 6" x 5'-6"	1 PC 2" x 6" x 10'-0"
6	8 PC 1" x 6" x 5'-4"	6 PC 1" x 6" x 14'-0"
7	2 PC 2" x 6" x 5'-0"	CUT FROM ROLL
8	12 PC 1" x 6" x 6'-0"	
9	2 PC 36" x 7'-0" ROOFING	
10	4 1/2" x 4 1/2" MACHINE BOLTS	
11	8 1/2" FLAT WASHERS	
12	5# 8d NAILS	
13	2# 16d NAILS	
14	1# ROOFING NAILS	

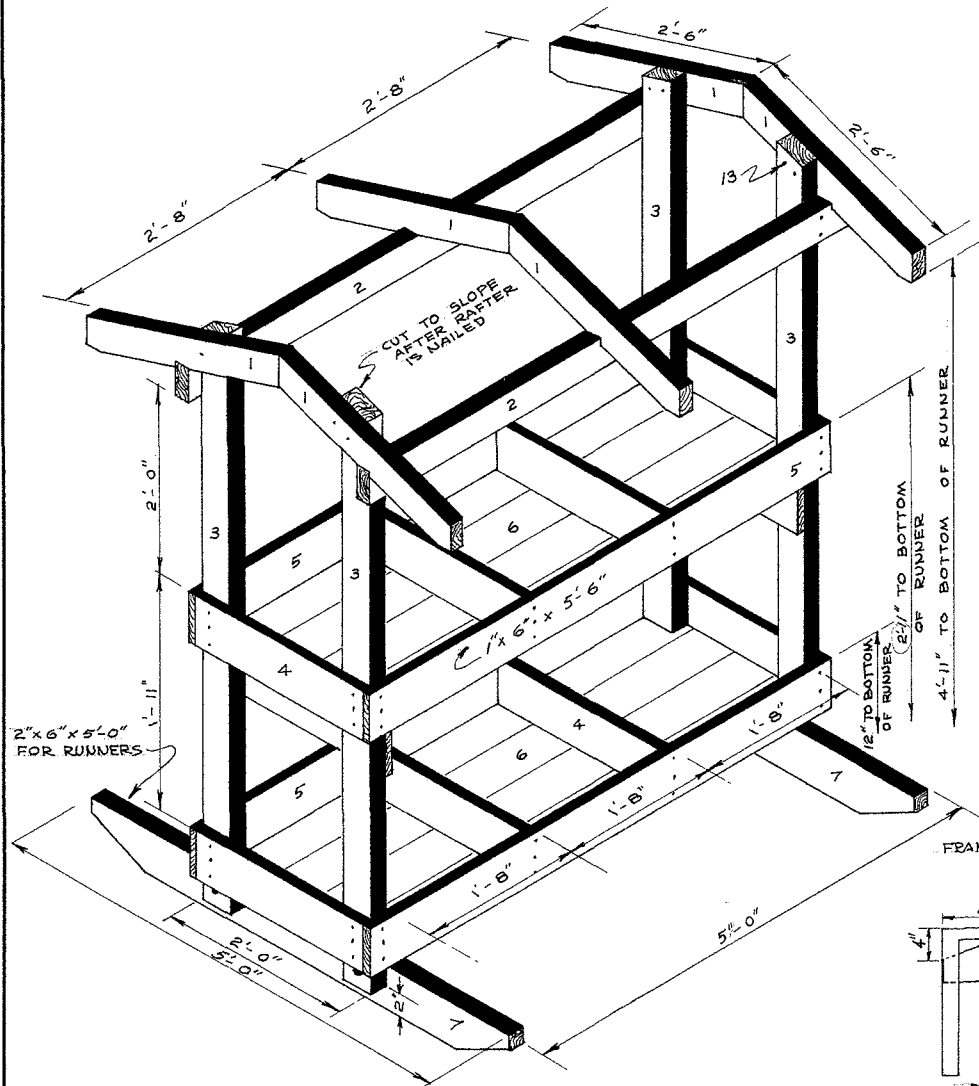

DETAILS OF FRAMING

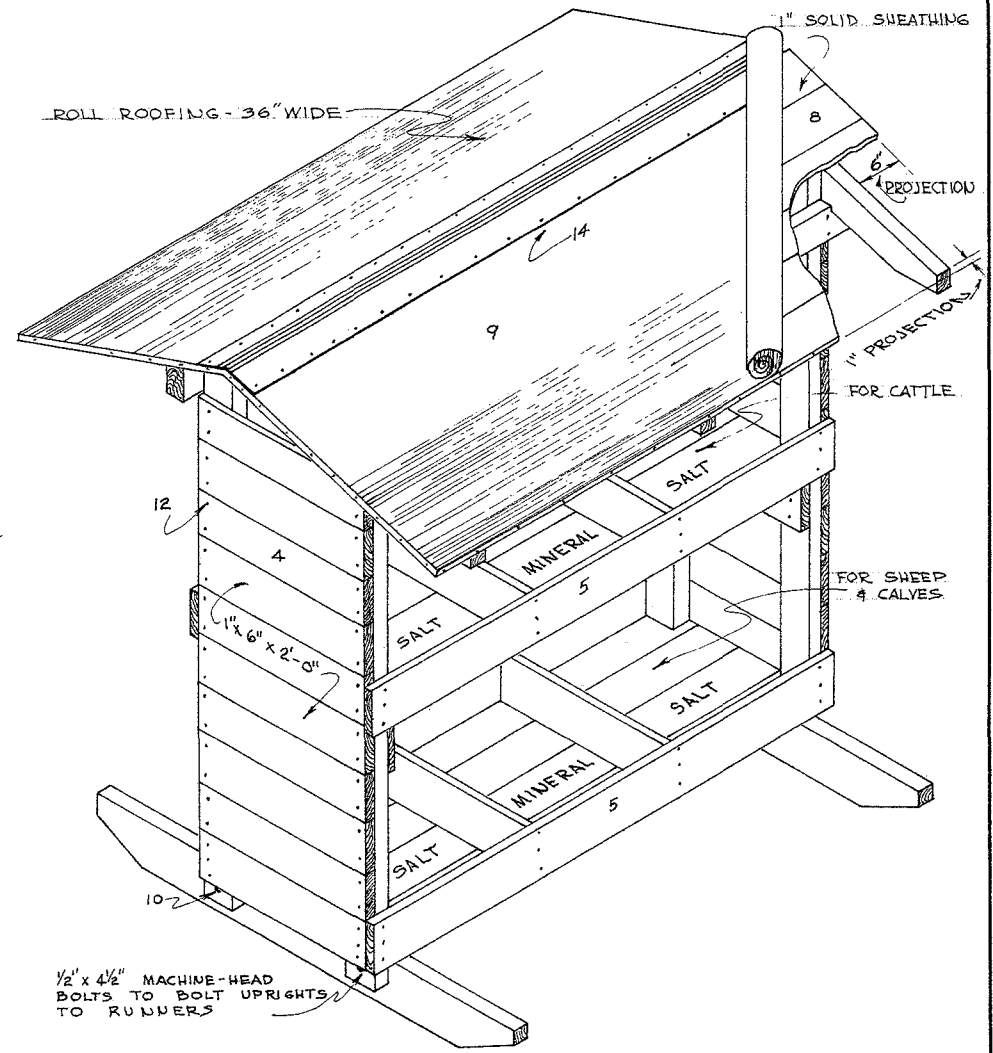

VIEW OF COMPLETE BOX

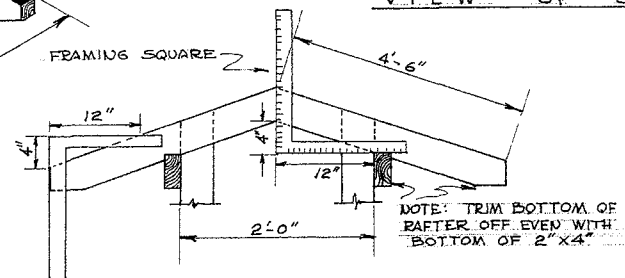

DETAILS OF RAFTER

SALT AND MINERAL BOX

ENGINEER	SCALE
DRAWN BY	SHEET 1 OF 1
TRACED BY DAW	DATE 1-30-64 NO. 5769

Disclaimer

This site makes available conceptual plans that can be helpful in developing building layouts and selecting equipment for various agricultural applications. These plans do not necessarily represent the most current technology or construction codes. They are not construction plans and do not replace the need for competent design assistance in developing safe, legal and well-functioning agricultural building system. The LSU Agriculture Center, the Mid-West Plan Service, the United States Department of Agriculture and none of the cooperating land-grant universities warranty these plans.